

Request for Information from Records



**Aboriginal Areas
Protection Authority**
protecting sacred sites across the territory

Select one of the follow record type for your information:

- ☒ **Abstract of Records** - receive a letter and / or map of your request
☐ **View Registered Sites** - Sacred Sites that have been Registered by the Authority
☐ **View Authority Certificate** - Authority Certificates can be viewed within Darwin or Alice Springs Office
☐ **Other** - agreement dependent information

Application made by: ANDREW JETNER

On behalf of Employer/Company/Client: MINESITE SERVICES AUSTRALIA

ABN: 95 896 386 789

Postal Address: PO Box 96 PALMERSTON NT 0831

MOB 0447 092 764 Phone: _____ Fax: _____

Email Address: andrew@minesiteservices.com.au

Proposed Use of Information: (eg, mining, house purchase) _____

MINERAL EXPLORATION

Description of Area of Interest: (address, location, attach map or coordinates & datum if possible)

MINERAL LEASE ML 29678

Comments: MAP ATTACHED

General Information:

Registered sites are sites that Aboriginal custodians have asked the Authority to protect and that have been documented and evaluated by the Authority.

Recorded sites are sites that have been made known to the Authority from a variety of sources including requests to have sites entered in the Register maintained by the Authority. In many cases the Authority has not been able to assess the accuracy of its information regarding recorded sites. However, the information regarding all sites should be noted carefully, since the offence provisions of the *NT Aboriginal Sacred Sites Act 1989* apply to all sacred sites, not only sites registered by the Authority. In some cases a tentative site boundary has also been defined. In other cases, recorded sites are represented by a site centroid only. The actual extent of the site may be much larger.

Inspection of the Authority's Records is not a definitive way of determining the location of all sacred sites in a given area, particularly where use of land may result in disturbance of features. There is a risk that a sacred site previously unknown to the Authority may be identified after the commencement of works, leaving no option but to cease works or possibly breach the offence provisions of the Act. If you wish to determine the constraints imposed by sacred sites on a particular area of land it is necessary to apply for an Authority Certificate. *Section 20* of the Act (Clause 1) states that "a person who proposes to use or carry out work on land may apply to the Authority for an Authority Certificate".

Under *Section 22* the Authority shall issue a Certificate when it is satisfied that:

The work or use of the land can proceed without there being a substantive risk of damage to a sacred site on or in the vicinity of the land or when an agreement has been reached between the Aboriginal custodians of any affected sites and the applicant for the Certificate, setting out conditions on which work may be carried out or use made.

The holder of an Authority Certificate is indemnified against prosecution under the Act if at any time in the future, it is argued that a sacred site has been damaged or entered and the holder of the Certificate can show that they acted in accordance with the provisions of the Certificate (Sections 25 & 33).

I Acknowledge that:

- (a) Provision of Information from Records does not constitute approval for works within the meaning of *Section 34(2)* of the Act. Information gained as a result of this request for Information from Records is not a definitive indication of the existence or lack of existence of sites in the area covered by this enquiry
- (b) Any material provided in response to this request may be used only for the purpose indicated and approved. Provision of this information to third parties may constitute a breach of *Section 38* of the Act

Signed: _____

W. J. H. E.

Date: _____

1/4/15

OFFICE USE ONLY: Job#:

Date sent:

Comments:

Darwin

P: +61 (08) 8999 5511
F: +61 (08) 8999 4332
enquiries.aapa@nt.gov.au
www.aapant.org.au
4th Floor R.C.G Building,
47 Mitchell Street Darwin NT
GPO Box 1890, Darwin NT 0801

Alice Springs

P: +61 (08) 8999 5511
F: +61 (08) 8952 2824
www.aapant.org.au
enquiries.aapa@nt.gov.au
Ground Floor, Belvedere House
Cnr Bath & Parsons Streets Alice Springs NT

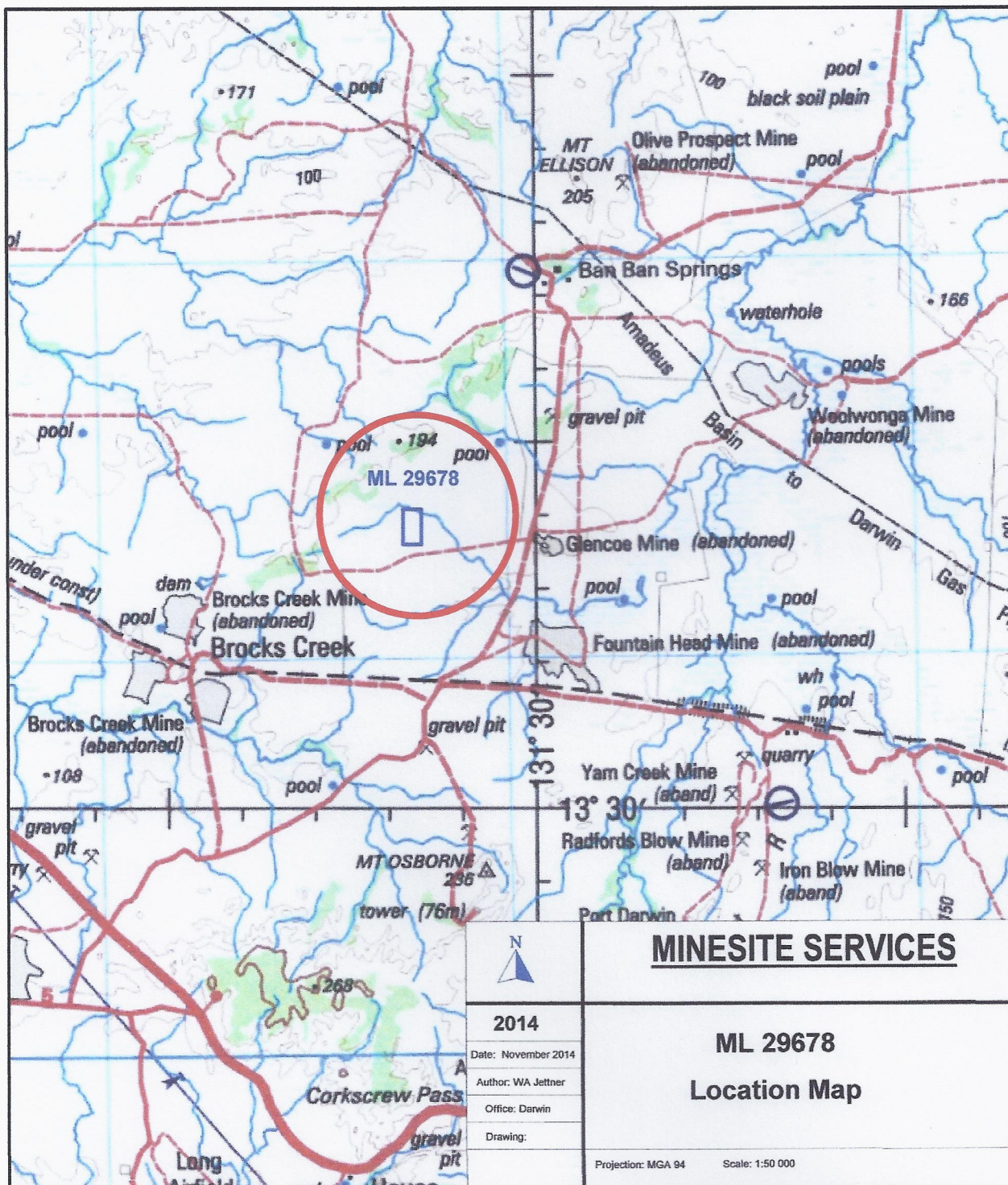

ML 29678 Location Map